

**Compact NSX100-250
FPower NSX**

Motor mechanism
Télécommande
Mando eléctrico

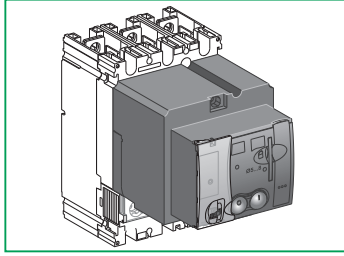

Marin Garin
Square D
Telemecanique

Schneider
Electric

GHD16272AA-05

Schneider Electric Industries SAS
89, boulevard Franklin Roosevelt
F-92505 Rueil-Malmaison Cedex (France)
Tel: + 33 (0)1 41 29 85 00
www.schneider-electric.com



© 2008 Schneider Electric.
All rights reserved.

IMPORTANT NOTE

- This device must be installed by a qualified electrician.
- We cannot accept any responsibility for failure to follow the instructions provided in this document.

REMARQUE IMPORTANTE

- L'installation de cet appareil doit être effectuée par des professionnels de l'électricité.
- Le non-respect des indications de la présente notice ne saurait engager la responsabilité du constructeur.

OBSERVACIÓN IMPORTANTE

- La instalación y mantenimiento de este aparato sólo debe ser realizado por electricistas profesionales.
- El fabricante no se hace responsable en caso de no cumplir con las indicaciones expuestas en este aviso.

重要注意事項

- 本装置必须由合格的电工进行安装。
- 我们不承担任何因未遵循本文档中的指南而导致的责任。

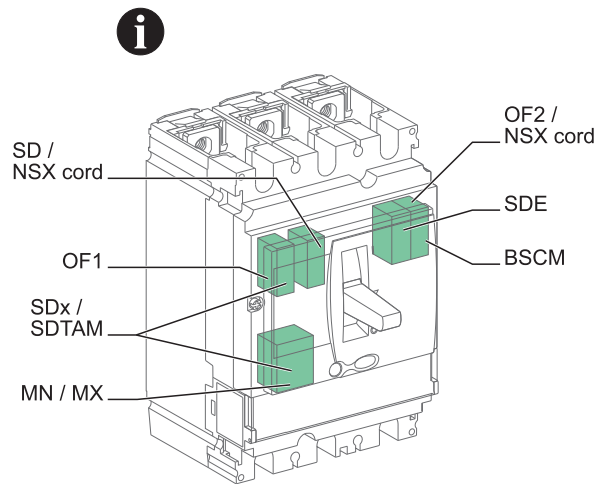
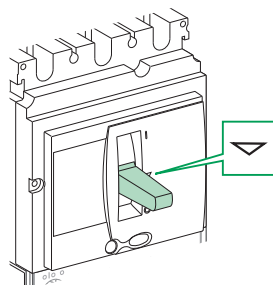
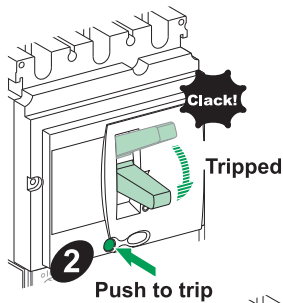
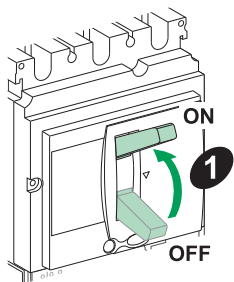
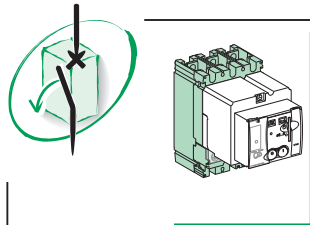
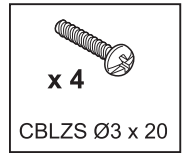
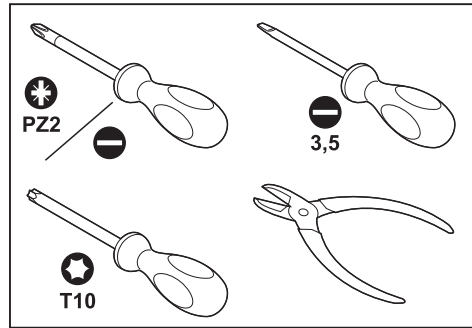
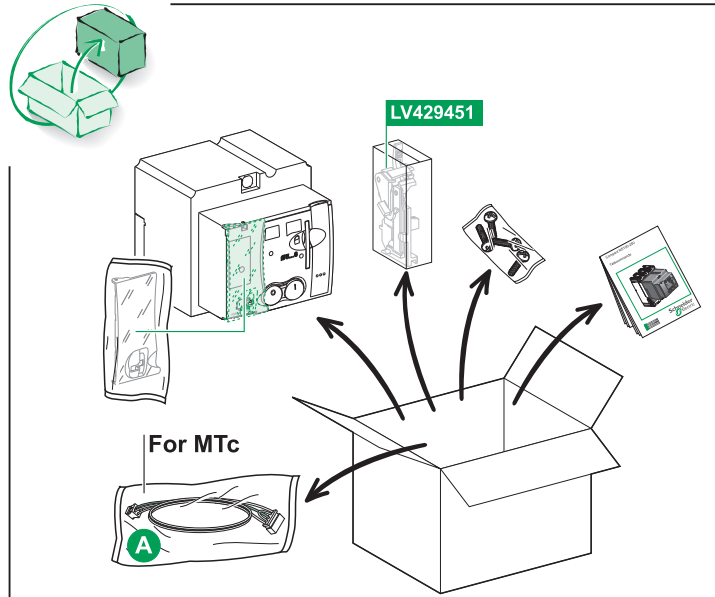

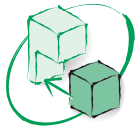

100	NSX100	MT100/160
150	NSF150	MT100/160
160	NSX160	MT100/160
250	NSX250/NSF250	MT250

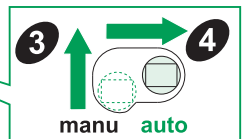
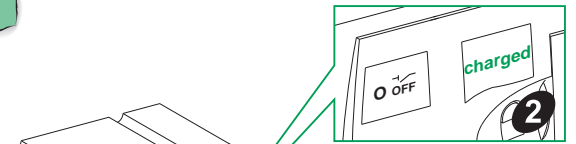
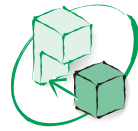
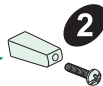
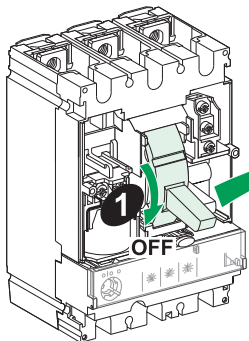
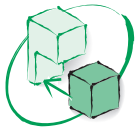
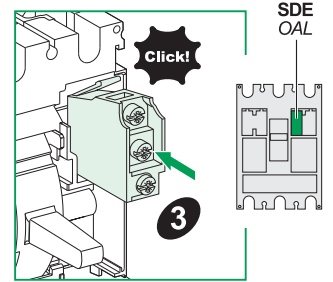
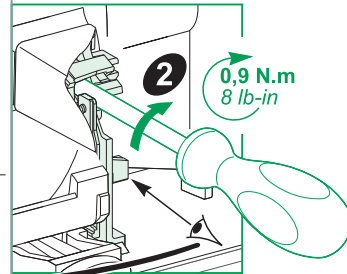
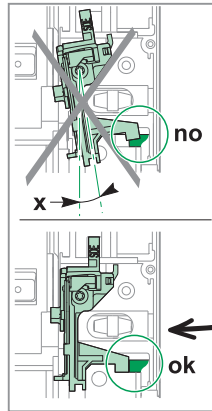
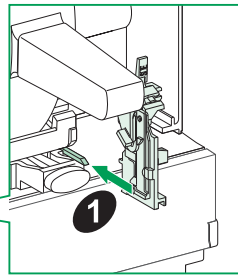
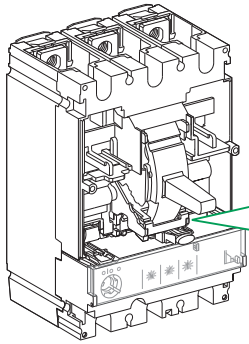
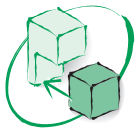
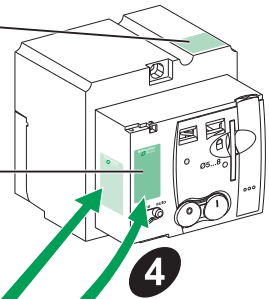
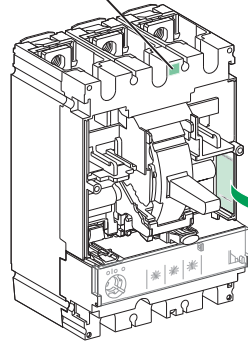
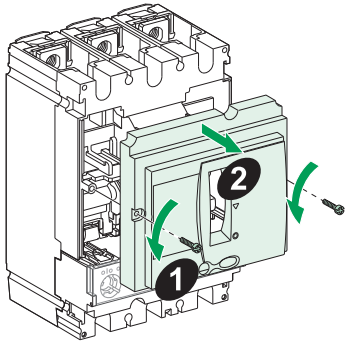

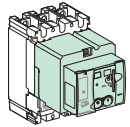
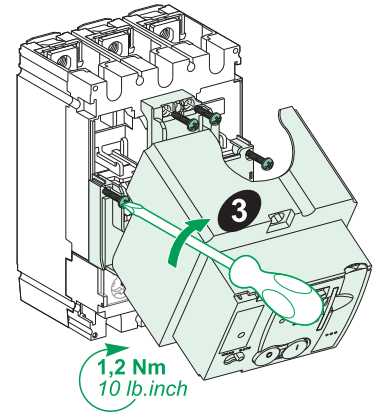
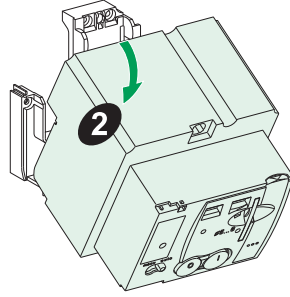
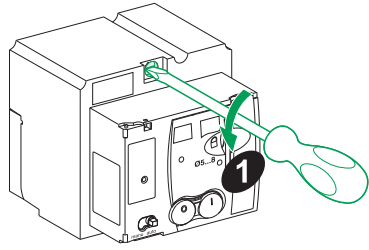
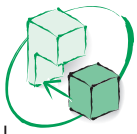

MT
(motor mechanism)

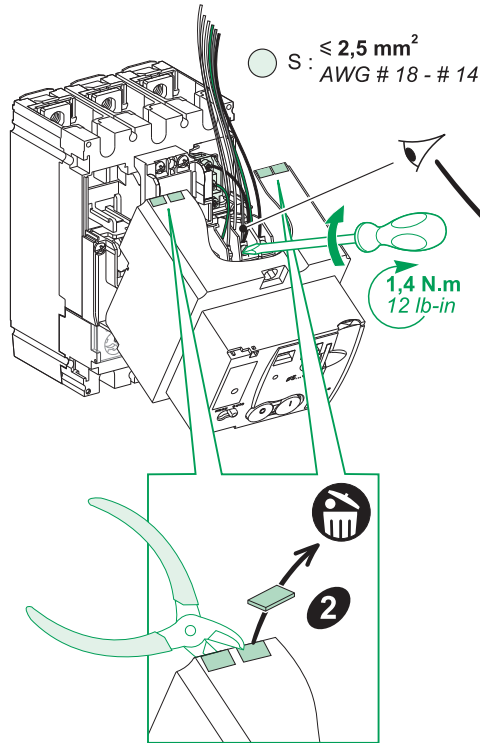
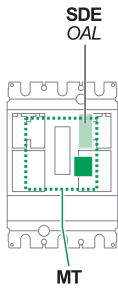

SDE
OAL

1

1,4 N.m
12 lb-in

MT

9 (A2)

2 (L1)

3 (A1)

8 (A4)

7 (B4)

1 (84)

2

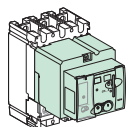
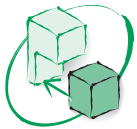

MTc
(communication motor mechanism)

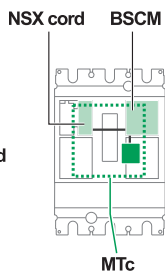

MTc
+
NSX cord
+
BSCM

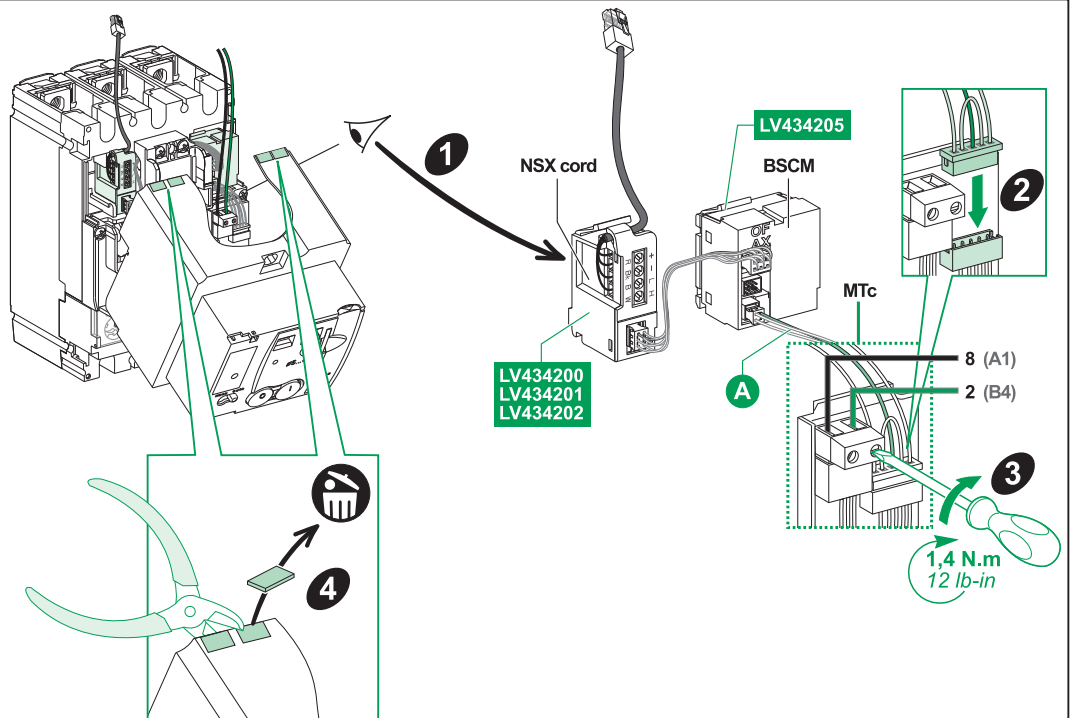

1

NSX cord

LV434205

BSCM

2

MTc

8 (A1)

2 (B4)

3

1,4 N.m
12 lb-in

LV434200
LV434201
LV434202

A

4

